

Modernizations

SYNTEGON

PROCESSING & PACKAGING

Centerlining Kit for Elematic 3001 Case Packers.

Stable processes through reproducibility of formats

To ensure a consistently high quality of your packaging, we developed the **Centerlining Kit** for the **Elematic 3001 WAH, WA / Midi and Compact** machine types. With this kit, the factory settings of all format positions can be precisely determined and documented.

This allows you to visually check the settings of all modules, for example during troubleshooting, and to correct any incorrect settings quickly and easily. Thanks to the precise reproducibility of the mechanical format settings, you increase the efficiency of your production operations and ensure stable processes.

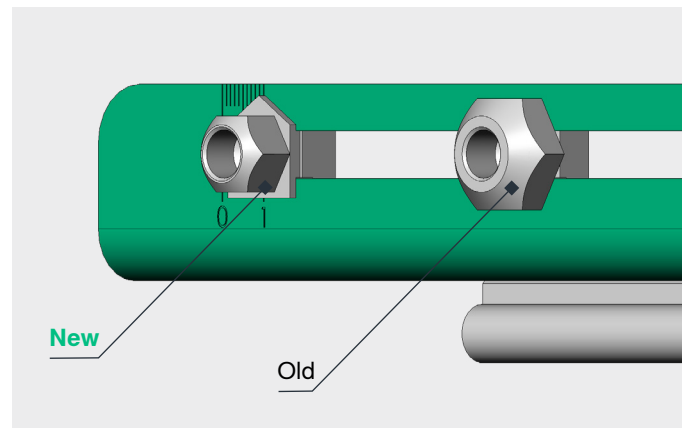

YOUR BENEFITS

- ▣ More stable processes
- ▣ Higher productivity
- ▣ Efficient troubleshooting
- ▣ Time and cost savings

All adjustable modules come with engraved measuring rods that are resistant to impact and abrasion and withstand any cleaning agents.

The new plug-in bolts have a smaller wrench size (13 mm instead of the previous 19 mm), thus ensuring easier handling. In addition, they are equipped with a pointer, which allows to determine the exact position.



Available Elematic 3001 Centerlining Kit modules

	Elematic 3001 WAH	Elematic 3001 WA / MIDI	Elematic 3001 Compact
Collation system			
Set: Locking pin mounting	62 pcs / format	41 pcs / format	37 pcs / format
Set: T-nut cassette	7 pcs / format	5 pcs / format	3 pcs / format
Product gathering	☐	☐	
Forming tube (hood)	☐		
Longitudinal gluing (hood)	☐		
Hood infeed	☐		
Hood stop	☐		
Prefeeder (hood)	☐		
Magazine	☐		
Basic machine			
Cassette	☐	☐	☐
Blank stop	☐	☐	☐
Top pressing	☐	☐	☐
Gluing unit	☐	☐	☐
Longitudinal gluing (tray)	☐	☐	☐
Side pressing	☐	☐	☐
Hood centering	☐	☐	☐
Forming tube (tray)	☐	☐	☐
Flap control	☐	☐	☐
Blank infeed	☐	☐	☐
Prefeeder (tray)	☐	☐	☐
Magazine	☐	☐	☐
Rotating pin	☐	☐	☐
Printer	☐	☐	☐

Examples Elematic 3001 Centerlining Kit modules

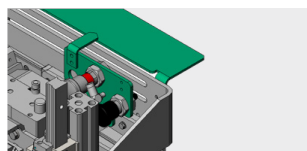

☐ Top pressing

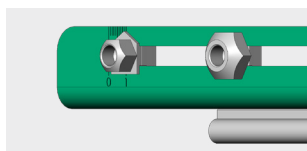

☐ Flap control

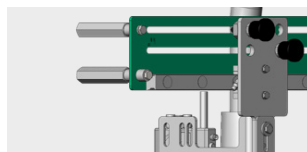

☐ Longitudinal gluing

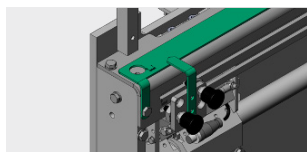

☐ Product gathering

The Centerlining Kit upgrade is suitable for all Elematic 3001 WAH, WA / Midi and Compact machines built from 2016.

The installation of the components is carried out by a Syntegon field service engineer who takes care of the on-site documentation of all format positions. The upgrade will take 2 working days to complete.

**Would you like to upgrade your machine?
Please request a machine-specific quote.**



**Got a question for
our experts?**

[Click here to find your
local contact](#)



**Already registered for
our E-Portal?**

[Get the latest information on
our parts and services](#)



**What's the level of
service you need?**

[Click here to get your
Service Agreement now](#)